

GOBI TOYOTA LAND CRUISER 80 REAR DOOR LADDER FOR REAR SPOILER INSTALLATION INSTRUCTIONS

The Gobi ladder must be inspected before each use to make certain attachments are secure, and for evidence of Wear. Misuse of the ladder or failure to observe the manufacturer's instructions as to installation, proper Attachment and maintenance will void any warranties that may be implied by law.

CAUTION

**"LADDER IS TO BE TRAVERSED UPON
ONLY
WHEN THE REAR DOOR TAIL GATE
AND LIFT GATE ARE FULLY
CLOSED AND LOCKED"**

GOBI TOYOTA LAND CRUISER 80 REAR DOOR LADDER FOR REAR SPOILER INSTALLATION INSTRUCTIONS

Guidelines:

When using Load Carriers and Accessories, the user must understand the precautions. The points listed below will assist you in using the rack /carrier system and will encourage safety.

- For quality fits and safty, use only the recommended rack or accessory. Do not assume an accessory will fit, always check with dealer when obtaining new accessories. Use only approved accessories on load carriers. Using other brands will void your warrenty.
- Make sure all knobs, bolts, screws, straps, and locks are firmly attached, tightened and locked before every trip. Knobs, bolts, screws, straps, and locks must be periodically inspected for signs of wear, corrosion, and fatigue. Check your load at stops during the trip to insure continued fastening security.
- Check local and state laws governing projection of objects beyound the width of a vehicle. **Be aware of the width and height of your cargo since low clearance branches, bridges, and parking garages can affect the load** All cargo will affect the vehicle's driving behavior. Never drive with any lock, know, or rack in an open or unlocked position. All long loads such as, but not limited to sailboards, surfboards, kayaks, canoes, and lumber must be tied down front and rear to the bumpers or tow hooks, of the vehicle.
- Remove your rack accessories when they are not in use, before intering car washes, prior to taking in your vehicle for service, and whenever clearance may be an issue.
- All locks must be turned and moved periodically to insure smooth operation. Use graphite or similar dry lubricant to help this. Locks are designed to deter vandalism and theft. Remove valuable gear if your vehicle is unattended for an extended period. Place at least one key in the glove compartment.
- For safety to your vehicle and rack system, obey all posted speed limits and traffic cautions. Adapt your speed to the conditions of the road and the load being carried.
- Do not use load carriers and accessories for purposes other than those for which they were designed. Do not exceed their carrying capacity.
- Consult with your dealer if you have any questions regarding the operations and limits of this product. Review all instructions carefully.

READ ALL INSTRUCTIONS CAREFULLY
PRIOR TO INSTALLATION

GOBI TOYOTA LAND CRUISER 80 REAR DOOR LADDER FOR REAR SPOILER INSTALLATION INSTRUCTIONS

Included in kit

Letter	Description	Location	Quantity
A	GOBI LAND CRUISER 80 LADDER FOR REAR SPOILER	Main box	1
B	LOWER LADDER CLAMP	strapped to ladder	1
C	LADDER HANGER PLATE	strapped to ladder	1
D	GOBI LADDER MOUNTING HARDWARE CONTENTS: 2-5/16" x 18 Stainless Nuts 2-5/16" Stainless Lock washers 2-5/16" Black neoprene stainless washer 1-3/16 allen wrench 1-1/8" allen wrench 2- 5/16 x 1" Button head Screw SS 2- 5/16" Flat washers SS 2- 5/16" Lock washer SS 1- Packet Anti- Seize Lubricant	BAG #1 Pre-assembled to bottom of ladder	1

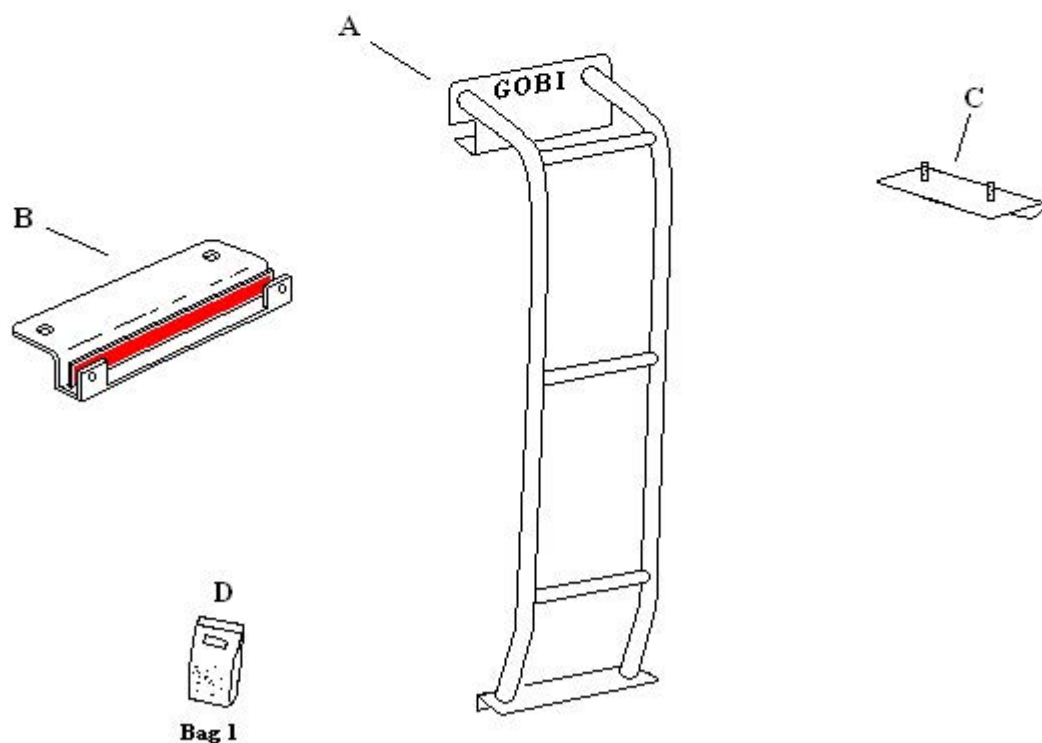

GOBI TOYOTA LAND CRUISER 80 REAR DOOR LADDER

FOR REAR SPOILER

INSTALLATION INSTRUCTIONS

CAUTION:
MAKE CERTAIN TO USE ANTI-SEIZE
LUBRICANT ON ALL SCREWS AND NUTS

Fig. 1**Fig. 2**

Make certain gap (G) shown in Fig. 1 is at least $\frac{3}{8}$ " wide. If gap is smaller refer to Fig. 2 and lift tail gate up completely. Loosen both screws (S) of the driver side hinge using a 12mm socket. Follow by loosening only the left screw of the passenger side hinge. Pull the driver side of the rear door out towards the rear of the vehicle as much as needed to open the gap then tighten only the left side screw of the driver side hinge. Go to the passenger side and loosen the remaining tight screw on the passenger hinge and pull out on the door in the same manner as the driver side then tighten one screw. Close tail gate completely and check the gap to make certain it is at least $\frac{3}{8}$ " wide across the top. If gap is good tighten all hinge screws. If gap is still too small repeat the above steps until gap is at least $\frac{3}{8}$ " wide.

GOBI TOYOTA LAND CRUISER 80 REAR DOOR LADDER FOR REAR SPOILER INSTALLATION INSTRUCTIONS

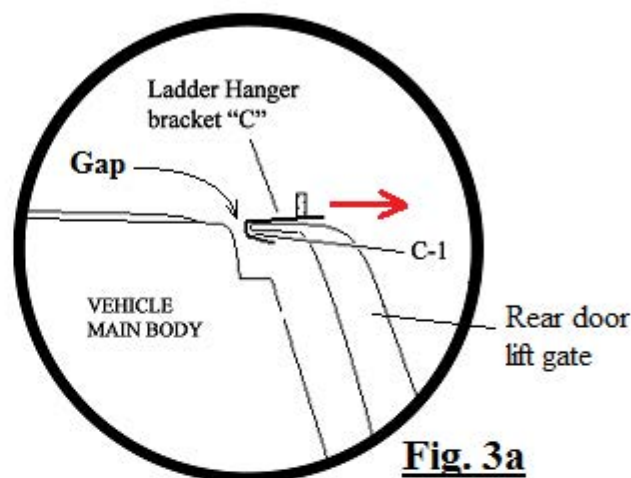
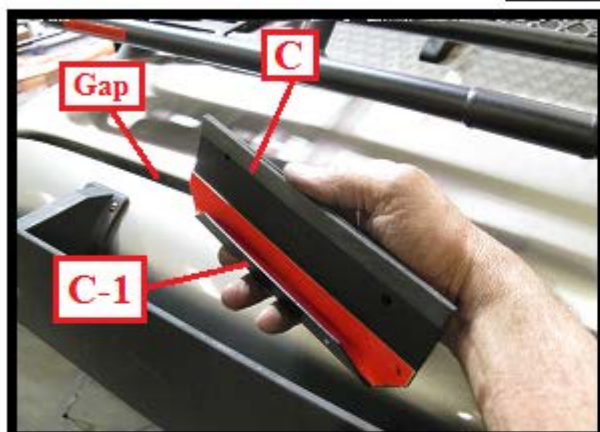
Fig. 3**Fig. 3a**

Make certain tail gate is fully closed then remove hanger plate (C) from your hardware kit. Do not peel off the red protective double back tape film at this time. As shown in Fig. 3 and 3a slip hanger plate's hooked end (C-1) into the gap between the roof top and the tail gate. As shown in Fig. 3a and 4 pull back hanger plate (C) in the direction of the red arrow so that the inner edge (C-1) of the hanger plate (C) is in full contact with the rear door's upper edge and the left-hand spoiler support (H) shown in Fig. 4 and 5. Hold hanger plate (C) firmly in place and apply two pieces of masking tape to prevent any movement temporarily as shown in Fig. 4.

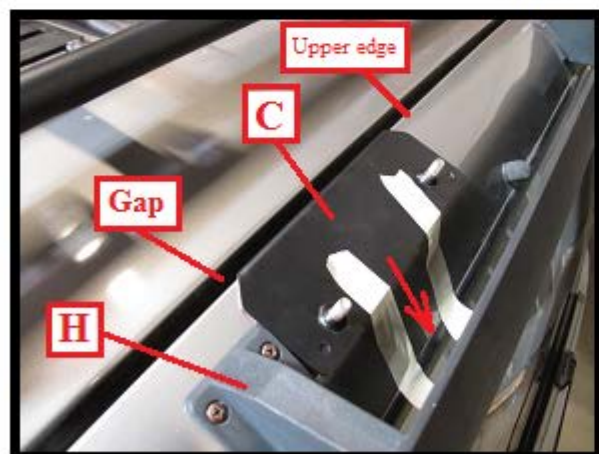
Fig. 4

Pull back hanger plate (C) in the direction of the red arrow and against the inside edge of rear spoiler support (H). Firmly hold in place and apply masking tape as shown to hold temporarily.

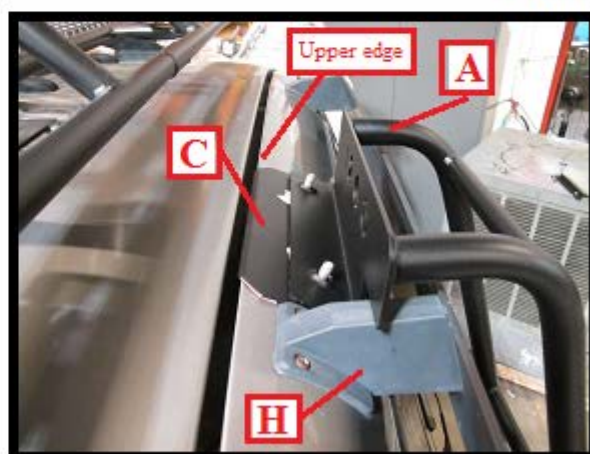
Fig. 5

Remove ladder (A) from your packaging and hang ladder onto hanger plate (C) as shown in Fig. 5 and 6. Do not remove the red double back tape protective film at the bottom of ladder.

GOBI TOYOTA LAND CRUISER 80 REAR DOOR LADDER FOR REAR SPOILER INSTALLATION INSTRUCTIONS

Fig. 6

Make certain ladder (A) hangs vertically straight up and down by sight or use a level if available.

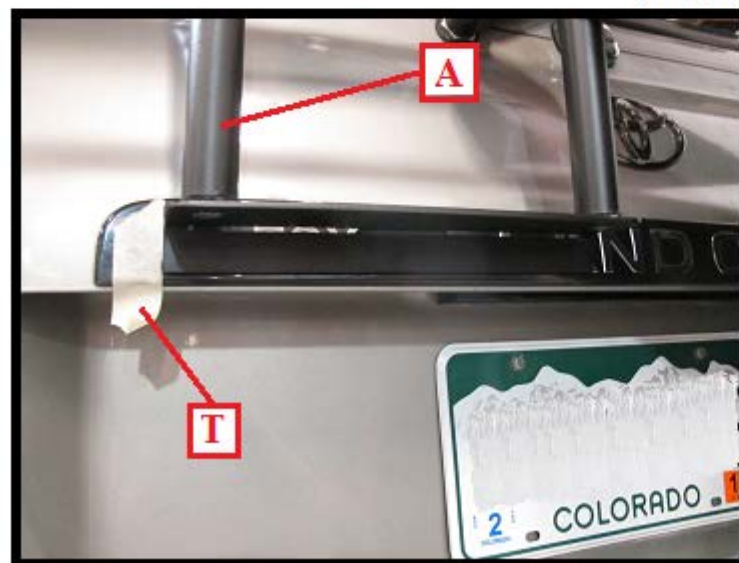
Fig. 7

While ladder (A) sits vertically straight up and down on the rear door carefully place a piece of masking tape (T) as a marker to the bottom left side of the ladder directly on the door as shown in Fig. 7. Remove both Allen head screws, lock washers and flat washers located at the bottom of the ladder with the supplied 3/16" Allen wrench located in Bag #1 of your hardware kit. Place screws in a location nearby as they will be needed shortly. Remove the ladder at this time.

GOBI TOYOTA LAND CRUISER 80 REAR DOOR LADDER FOR REAR SPOILER INSTALLATION INSTRUCTIONS

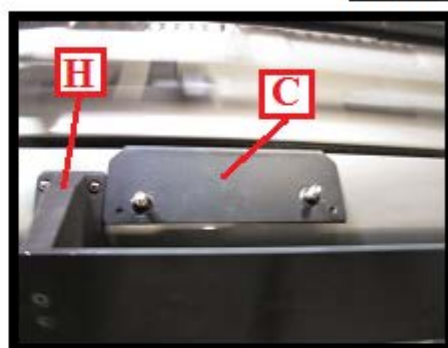
Fig. 8**Fig. 9**

Remove hanger plate (C) from the top of the rear door and discard masking tape. Clean the area where the hanger plate sat with denatured alcohol. Peel off the red protective double back tape shown in Fig. 8 and carefully install hanger plate (C) back in place on the rear door as shown in Fig. 3a and 4 and Fig. 9 above. Remember to make certain that hanger plate is touching the side of spoiler support (H) as shown in Fig. 9.

Fig. 10

Lift up the rear tail gate and clean the area outside and below the lower lip of the door to the right side of the masking tape marker with denatured alcohol. Remove any dirt or debris.

GOBI TOYOTA LAND CRUISER 80 REAR DOOR LADDER FOR REAR SPOILER INSTALLATION INSTRUCTIONS

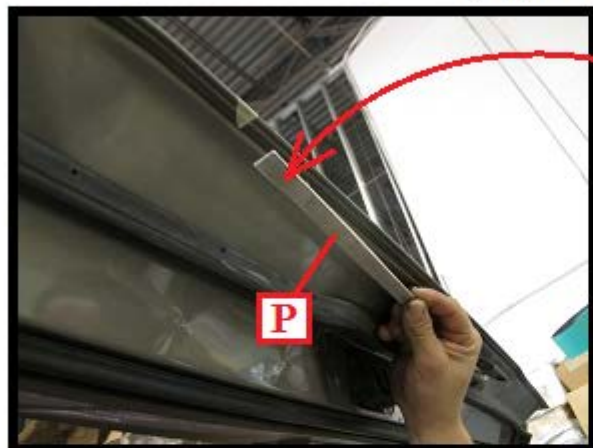
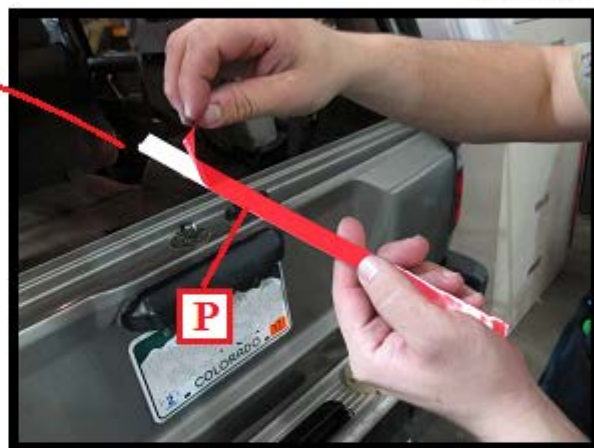
Fig. 11**Fig. 12**

Remove clamp (B) from your hardware kit. Take out from clamp (B) pinch plate (P) shown in Fig. 12 and 11. Peel off the red double back adhesive tape film and stick to the underside of the rear door even with the lower lip as shown in Fig. 11 from the masking tape marker right.

Fig. 13**Fig. 14**

Remove the red double back protective film from the bottom of ladder (A) then set the ladder back up onto hanger plate (C) as shown in Fig. 5. Pull the ladder down firmly and line up the bottom of the ladder as much as possible with the lower door lip and to the edge of the masking tape marker as shown in Fig. 14. Hold in place for at least 30 seconds.

GOBI TOYOTA LAND CRUISER 80 REAR DOOR LADDER FOR REAR SPOILER INSTALLATION INSTRUCTIONS

Fig. 15**Fig. 16**

While holding ladder (A) in place on the back-door slide at the same time clamp (B) up onto the rear door bottom lip (L) and under ladder (A) as shown in Fig. 15 and 16. Thread back in place the two 5/16 button head screws, lock washers and flat washers removed earlier with the 3/16" Allen wrench located in Bag #1 of your hardware kit. While pulling down on the ladder fully tighten both screws in place.

Fig. 17

Tighten both Allen set screws (SS) using the 1/8" Allen wrench located in Bag #1. Turn set screw in until it makes contact with the pinch plate then only two to three full turns after. Tighten the outside nut using a 7/16" open end wrench.

Fig. 18

Remove two 5/16" cupped shaped neoprene washers, lock washers and nylock nuts from Bag #1. Thread both washers, lock washers and nuts in place onto the threaded studs of hanger plate (C). Fully tighten down using a 7/16 wrench. "Do not over tighten". Remove all masking tape markers.

GOBI TOYOTA LAND CRUISER 80 REAR DOOR LADDER

FOR REAR SPOILER

INSTALLATION INSTRUCTIONS



INSTALLATION COMPLETED